

Prescott Street, Leigh, WN7 1RB
Offers Over £140,000

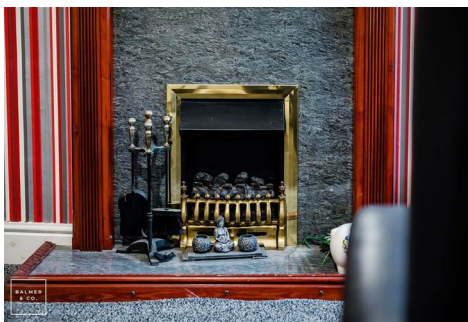

BALMER & CO in LEIGH are delighted to offer FOR SALE this fantastic two bedroom end-terrace house in Leigh. Offered with no onward chain, this property is very nicely presented throughout and offers larger than average living space. Comprising in brief of entrance hallway, living room, sitting room with feature gas fireplace and surround, with a modern fitted kitchen with appliances beyond completing the ground floor. To the first floor is a large master bedroom with fitted wardrobes, second double bedroom with fitted cupboard, with a modern four piece family bathroom completing the accommodation on offer. Externally the property is pavement fronted, whilst to the rear there is a small yard with a detached garage. Early viewings highly recommended, all enquiries welcome.

Floor Plan

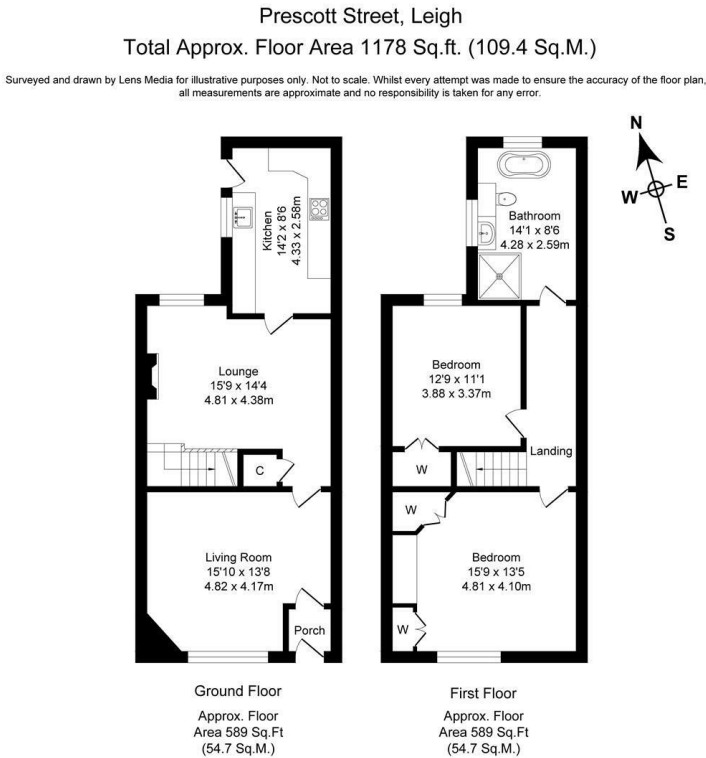

Area Map

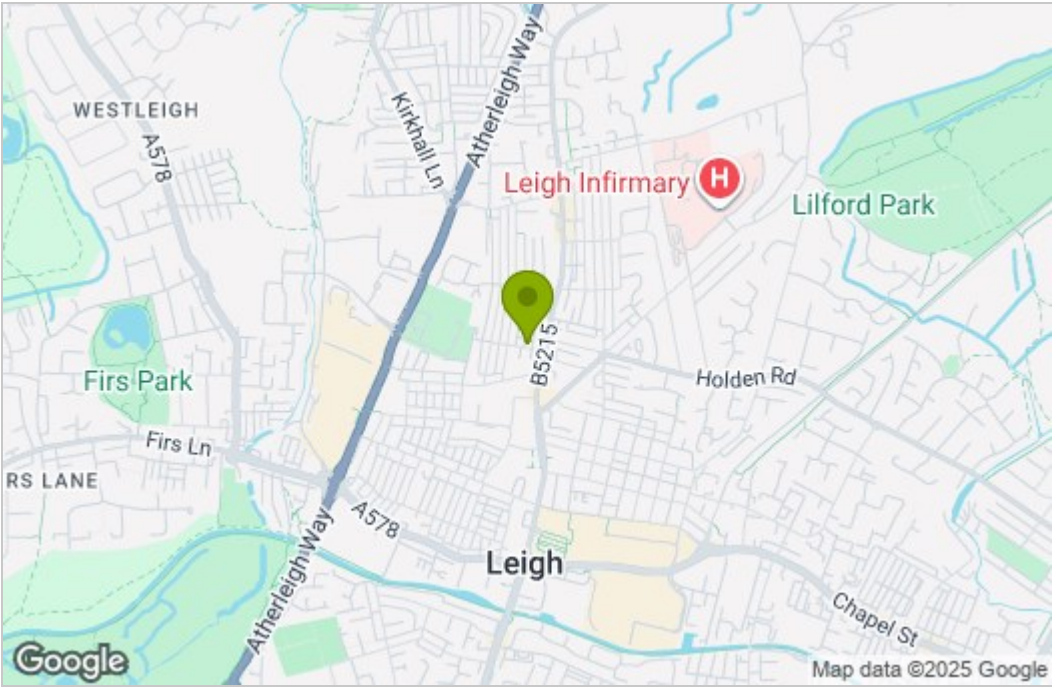

Energy Efficiency Graph

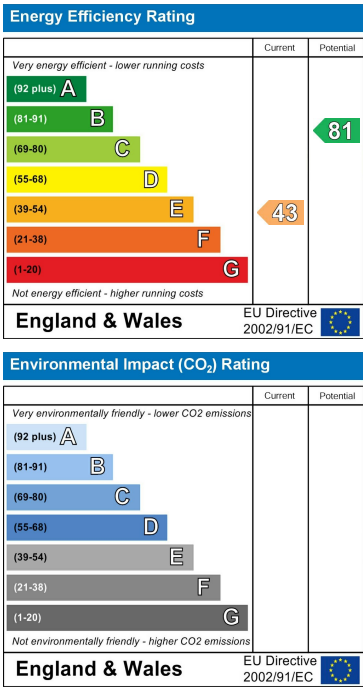

These particulars, whilst believed to be accurate are set out as a general outline only for guidance and do not constitute any part of an offer or contract. Intending purchasers should not rely on them as statements of representation of fact, but must satisfy themselves by inspection or otherwise as to their accuracy. No person in this firms employment has the authority to make or give any representation or warranty in respect of the property.